

# Eiermann 1



# Eiermann 1

## Accessories



### Rubber stoppers

for 660m frames (without height adjustment rods)  
rubber stoppers for the height adjustment rods

1 set of 4

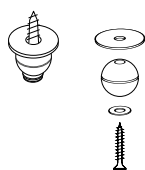

### Latching set

Plastic balls screwed to the table top and inserted into the frame/extension rods by way of securing table top

1 set of 4

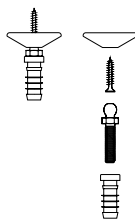

### Top fixing set

for securing acutely tilted tabletops, for use with extension rods  
Height +20 mm

1 set of 4



### Rampa coupling Tabletop

inserted into the underside of the tabletop for secure screwing to the frame.  
Mounting bracket required

1 set of 4



### Cable grommet

Cable grommet placed according to order. Die-cast zinc, powder coated  
ø = 67 mm

NEW

black, white, Chrome look



NEW

### Felt glides

For hard floor surfaces

1 set of 4

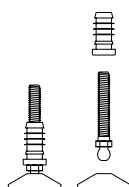

### Levelling feet

for uneven ground.  
Height +18 mm to 50 mm.  
Black plastic plate

1 set of 4

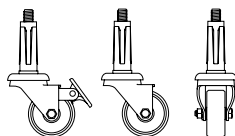

### Castors

Castor set with PU tread, 2 castors each with a brake  
Height +70 mm

Plastic sleeve  
low use



Metal sleeve  
medium use



Contract  
intense use

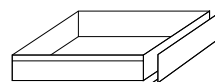

### Drawer

MDF Melamine white, optionally with front panel

small  
344 x 344 x 45 mm (inside)



Frontpanel steel  
powder coated



Frontpanel steel  
chrome-plated



large  
460 x 344 x 45 mm (inside)



Frontpanel steel  
powder coated



Frontpanel steel  
chrome-plated

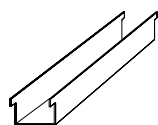

Cable trough,  
hanging  
Sheet steel

1100 x 120 x 60

powder coated



Chrome look

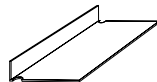

CPU Holder,  
hanging  
Sheet steel

660 x 220 x 85



780 x 220 x 85

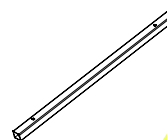

NEW

Tabletop support  
Steel powder coated  
(black, white)

1380 x 30 x 30

1 Satz (2 pcs)



powder coated

Chrome look

# Eiermann 1

## Conference Table

The popular Eiermann 1 table frame served as the template for this square frame variant with a fixed height and a tabletop that can be secured via screws.

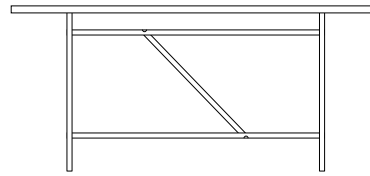

crossbar, central

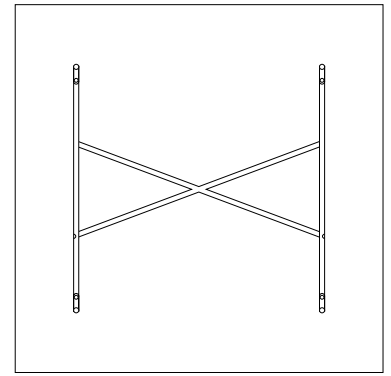

**Conference table, Frame, tubular steel**  
with mounting bracket  
1100 × 1100 × 690

**powder coated**  
● black RAL 9005  
○ white RAL 9010

**chrome-plated**  
● chrome

**Levelling feet**  
for uneven ground,  
Height +18 mm to 50 mm.  
Black plastic plate  
1 set of 4

**Felt glides**  
For hard floor surfaces  
1 set of 4

NEW

**Tabletop**  
incl. preinstalled Rampa coupling  
1600 × 1600 × 28/30

**Melamine 28 mm**  
solid oak edge  
○ white

**Linoleum Forbo 30 mm**  
solid oak edge  
● nero 4023

# Eiermann 1

## Children's Table

The popular Eiermann 1 table frame in a special set for children. The tabletop is firmly attached to the extension rods with screws. The table height can be easily adjusted.

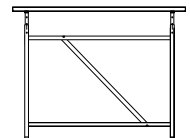
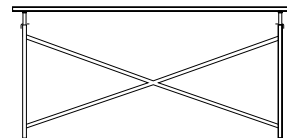

crossbar, central

**Children's table, Frame, tubular steel**  
including height adjustment rods with mounting bracket 335mm, 5 holes, hole interval 35 mm  
1100 × 660 × 520 – 690

**powder coated**  
● silver RAL 9006  
○ white RAL 9010

**Linoleum Forbo 30 mm**  
solid oak edge  
● smokey blue 4179  
● ash 4132

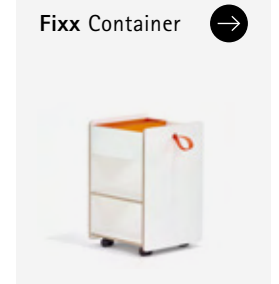
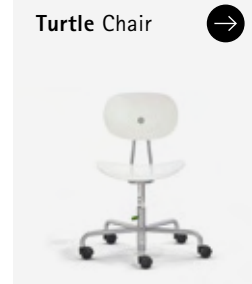

**Tabletop**  
incl. preinstalled Rampa coupling

**Melamine 28 mm**  
solid oak edge  
○ white

**Levelling feet**  
for uneven ground, Height +18 mm to 50 mm  
Black plastic plate

**Set price (frame & tabletop)**

**Set price (frame & tabletop)**

1200 × 700

1500 × 750

1 set of 4