

Power on/off:

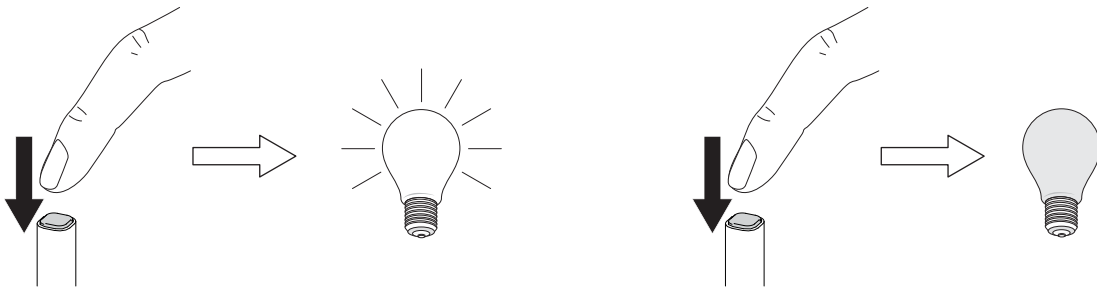

Dimming Function:

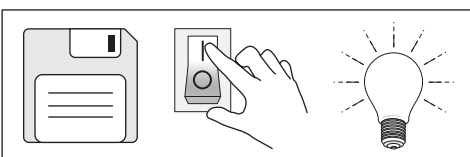
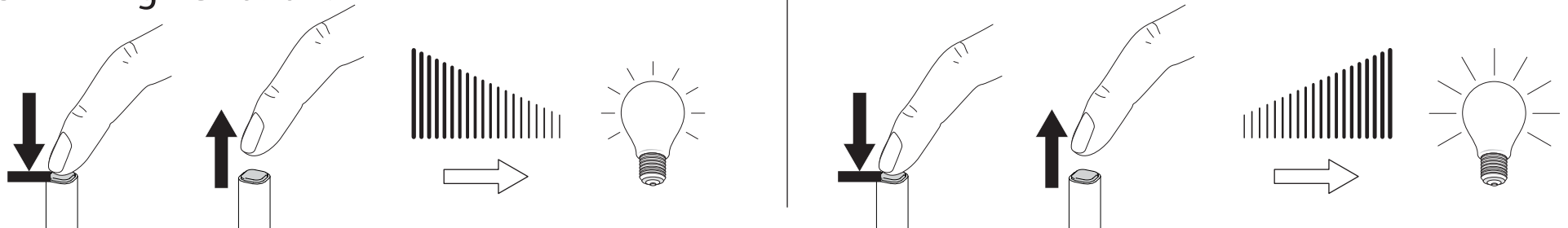

Set default brightness level (User Function) when connected to power:
Factory reset to deactivate brightness level when set

A

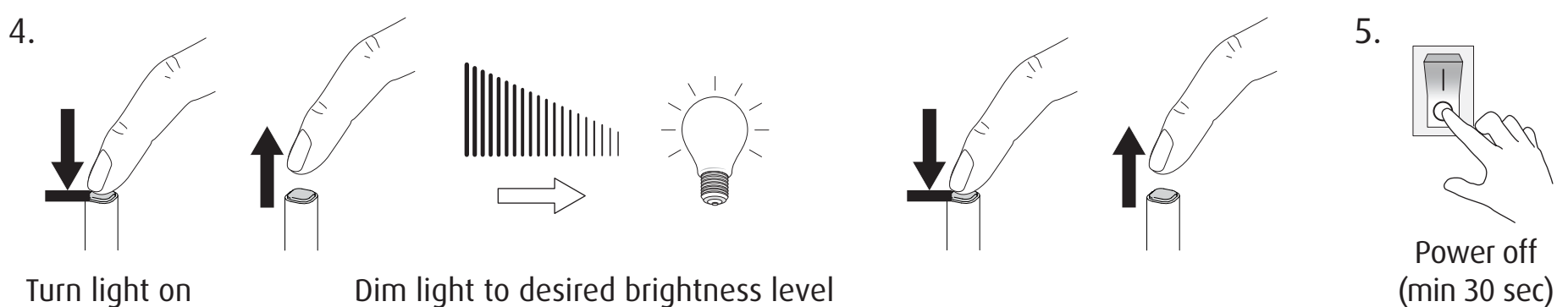
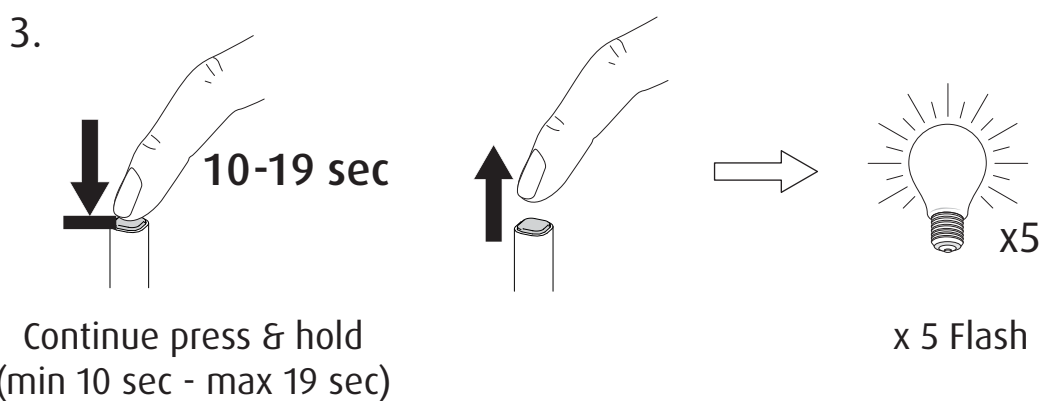
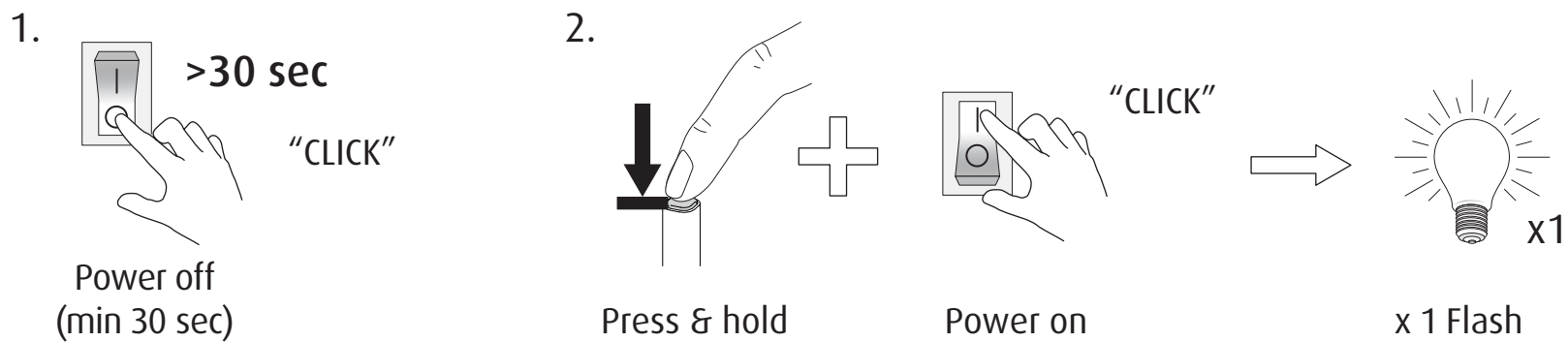

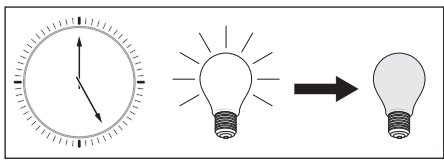

YUH - Electronics Function

26000-I2

2/2

B Timing Function (User Function)

Set timer to automatically turn off after period of time

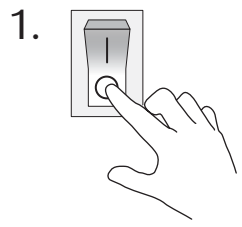

Power off
(min 30 sec)

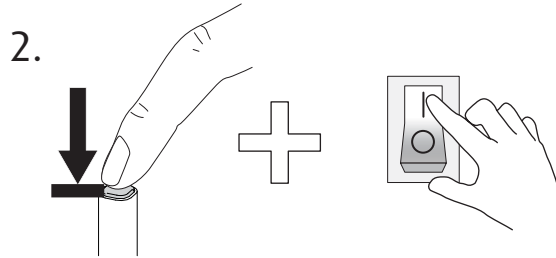

Press & hold

Power on

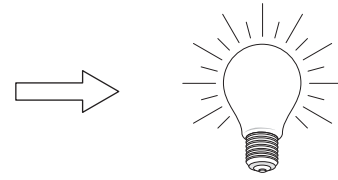

x 1 Flash

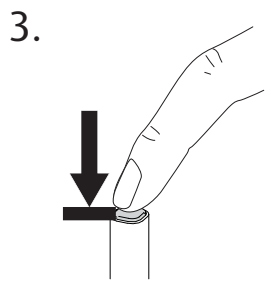

Continue press & hold
(min 5 sec - max 9 sec)

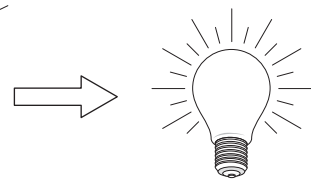
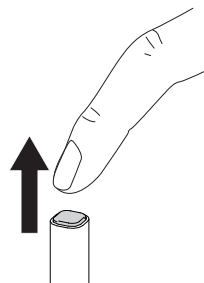

x 1 Flash

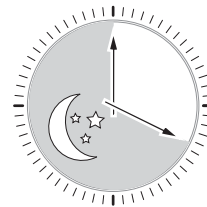
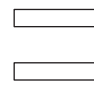

4 hours

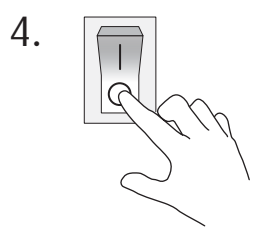

Power off
(min 30 sec)



Repeat 1.-3.

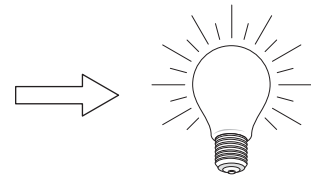

x 2 Flash

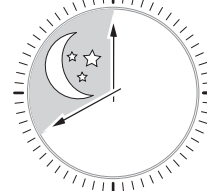
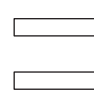

8 hours



x 3 Flash

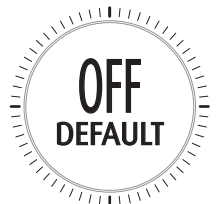
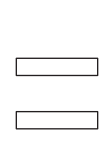

Timing function off



Restore factory default settings:

This is the standard setting for this product.

With this setting the on/off button and dimming function is active.

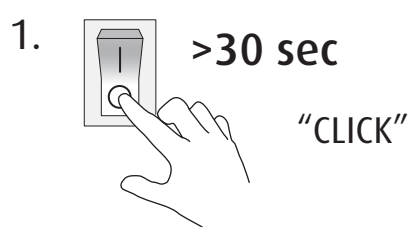

Power off
(min 30 sec)

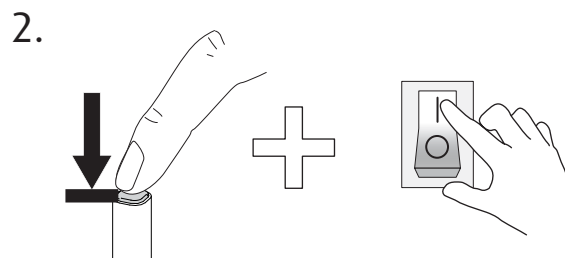

Press & hold

Power on

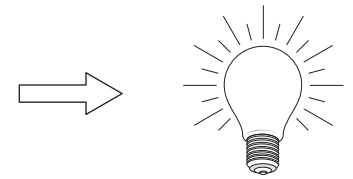

x 1 Flash

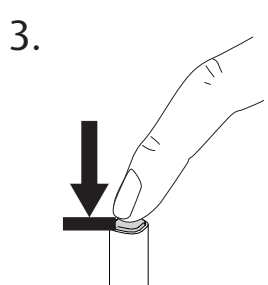

Continue press & hold
(min 20 sec)

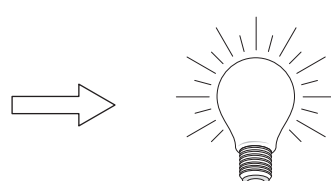
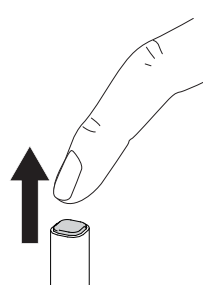

x 25 Flash

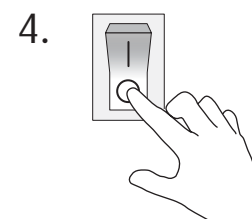

Power off
(min 30 sec)